

- NOTES:**
1. INSTALLATION MUST COMPLY WITH NATIONAL AND LOCAL ELECTRICAL REGULATIONS.
 2. PLEASE REFER TO THE PRODUCT MANUALS FOR DETAILED INFORMATION.
 3. ALL DIMENSIONS ARE IN MILLIMETERS [INCHES].
 4. NET WEIGHT OF UNIT IS 138.23 kg [343.1 LBS].
 5. CABLE ENTRY IS TOP OR BOTTOM OF UNIT.
 6. FRONT AND REAR SERVICE ACCESS REQUIRED.
 7. AIR FLOW AND SERVICE REQUIREMENTS, AS WELL AS MINIMUM CLEARANCE TO FIRE SUPPRESSION SYSTEMS SHOULD BE CONSIDERED WHEN LOCATING THE ENCLOSURE.

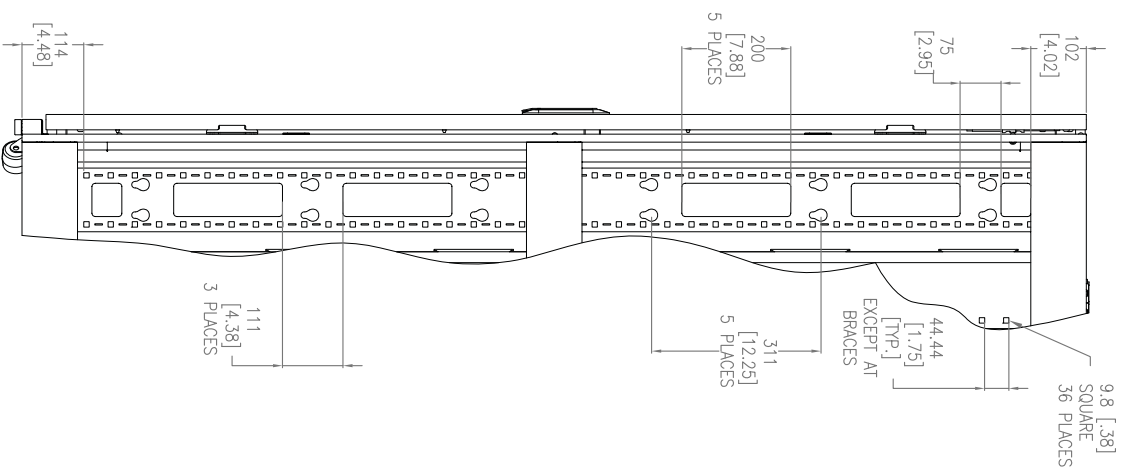

THIS DRAWING AND SPECIFICATIONS HEREIN ARE THE PROPERTY OF SCHNEIDER ELECTRIC AND SHALL NOT BE COPIED, REPRODUCED OR USED IN WHOLE OR IN PART, AS THE BASIS FOR THE MANUFACTURE OR SALE OF ITEMS WITHOUT WRITTEN PERMISSION FROM SCHNEIDER ELECTRIC. THIS DRAWING IS BASED UPON LATEST AVAILABLE INFORMATION AND IS SUBJECT TO CHANGE WITHOUT NOTICE.



TITLE: NetShelter SX 42U ENCLOSURE WITH SIDES DEEP 750mm WIDE x 1070mm MAIN MECHANICAL PROJECT: SUBMITTAL DRAWINGS SHEET 1 OF 3

DWG. NO.	REV.
AR3150	2
DRAWN BY: B ZAHN	15-JUL-09
ENGINEER: K THOMAS	15-JUL-09
APPROVED BY: [Signature]	15-JUL-09
	FIRST ANGLE PROJECTION

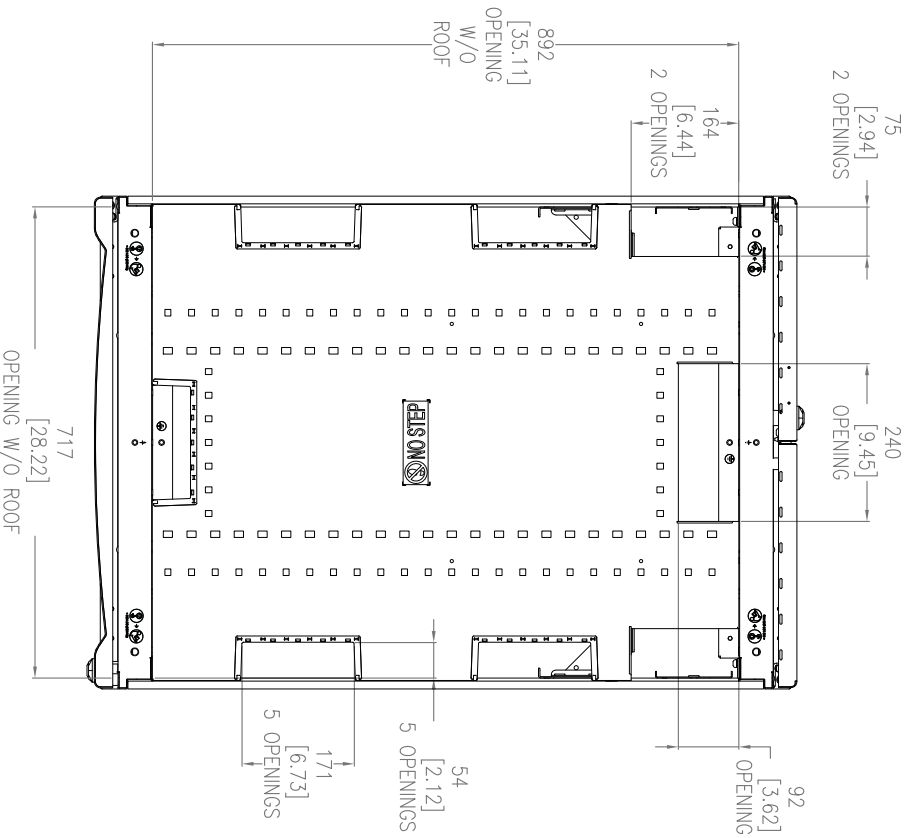

TOP VIEW
CABLE OPENINGS
(COVERS REMOVED)

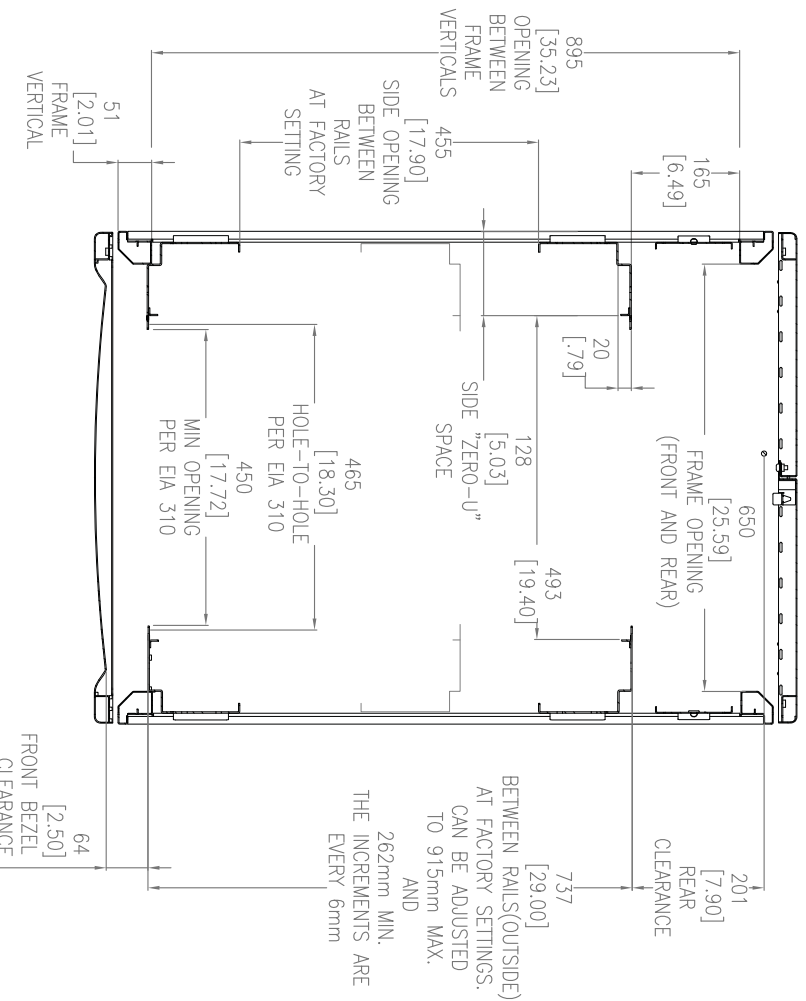

SECTION B-B
(VIEW FROM INSIDE CABINET
LOOKING DOWN)

NOTES:

1. INSTALLATION MUST COMPLY WITH ALL APPLICABLE NATIONAL AND LOCAL CODES.
2. ALL DIMENSIONS ARE MILLIMETERS [INCHES].

THIS DRAWING AND SPECIFICATIONS HEREIN ARE THE PROPERTY OF SCHNEIDER ELECTRIC AND SHALL NOT BE COPIED, REPRODUCED OR USED IN WHOLE OR IN PART, AS THE BASIS FOR THE MANUFACTURE OR SALE OF ITEMS WITHOUT WRITTEN PERMISSION FROM SCHNEIDER ELECTRIC. THIS DRAWING IS BASED UPON LATEST AVAILABLE INFORMATION AND IS SUBJECT TO CHANGE WITHOUT NOTICE.



TITLE:
Netspaller SX 42U
ENCLOSURE WITH SIDES
600mm WIDE x 1070mm DEEP
TOP VIEWS
PROJECT: SUBMITTAL DRAWINGS SHEET 2 OF 3

DWG NO:	AR3150	REV:	3
DRAWN BY:	B ZAHN	DATE:	15-JUL-09
ENGINEER:	K THOMAS	DATE:	15-JUL-09
APPROVED BY:	K THOMAS	DATE:	15-JUL-09
PROJECT:	AR3150	REV:	3

