

Installation Manual

Clear Aluminum
Black

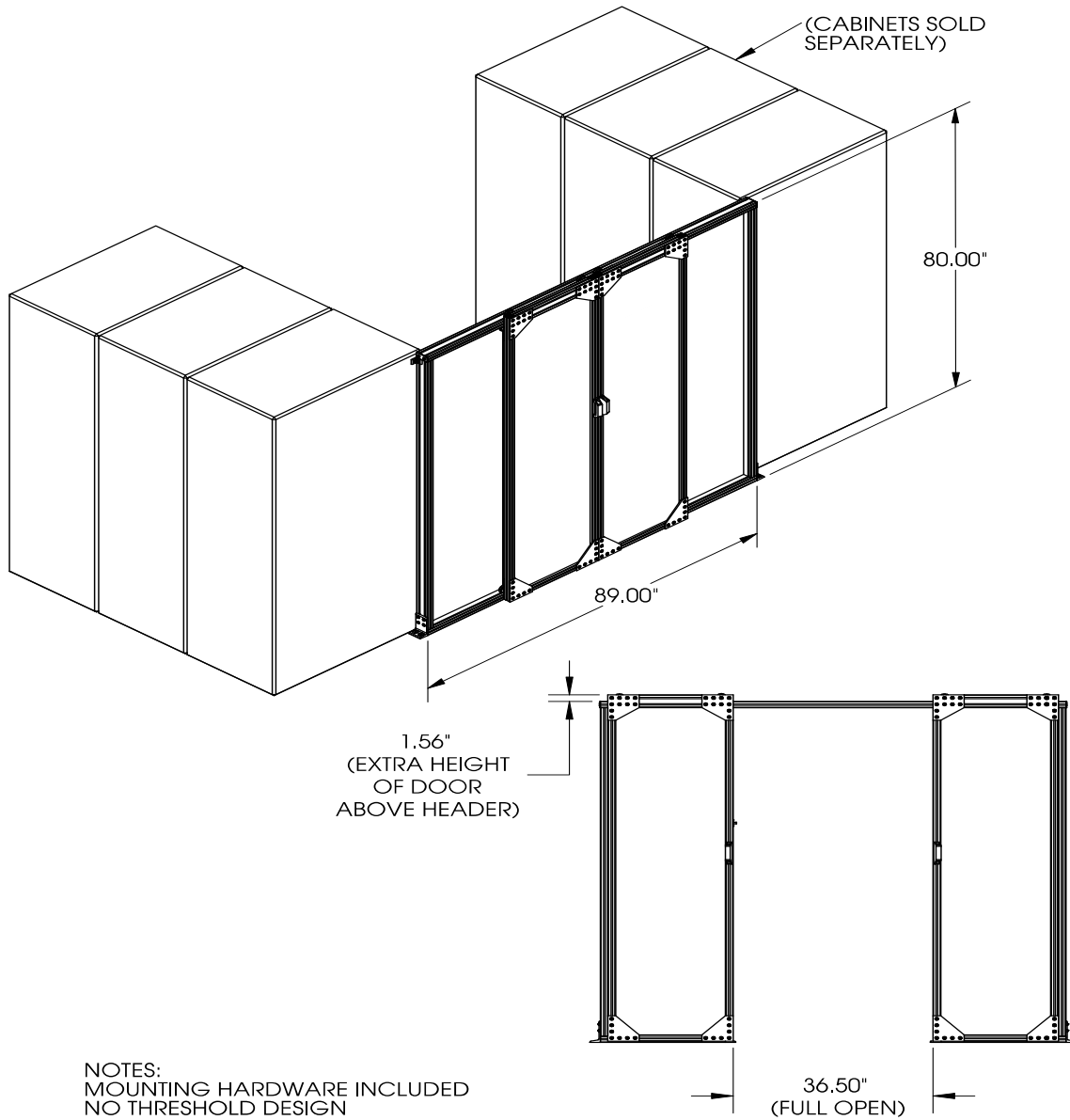

Aisle End Dual Sliding Door™ INSTALLATION MANUAL

1 Overview

The Emerson Aisle End Sliding Door™ (AED) is the factory recommended door system for both cold and hot aisle containment because it combines cost-effectiveness and ease of installation. Over the long-term the Aisle End Sliding Door™ will also reduce “total cost of ownership” by making it easier to fully separate cold supply and hot exhaust airflow. The sturdy aluminum frame will last a long time. Other features include a locking door, magnetic stays, and a no-floor threshold so as to eliminate a tripping hazard.

The AED kit includes all of the components and fasteners required to assemble and install the door. The door can be installed without having to ‘hang it’ onto the aisle end racks. Instead the door sits on the floor with two small attachments to the top of the racks.

The door is attached to the floor with four L brackets. The top is attached with two brackets to the top of the aisle end racks or alternately the side of the racks. The base can be attached into either the raised floor tiles or into a solid floor. The weight of the door rests on the floor. Once the doorposts are plumbed the doors will easily slide open and shut.

2 Components

The sliding door comes in five major components: The door frames, two sliding doors, and the doorframe header.

1. Left Hand Sliding Doors
2. Left Hand Frame
3. Right Hand Frame
4. Right Hand Door
5. Frame Header
6. Hardware Kit (Not Shown)

Figure 2

This view shows the separated components.

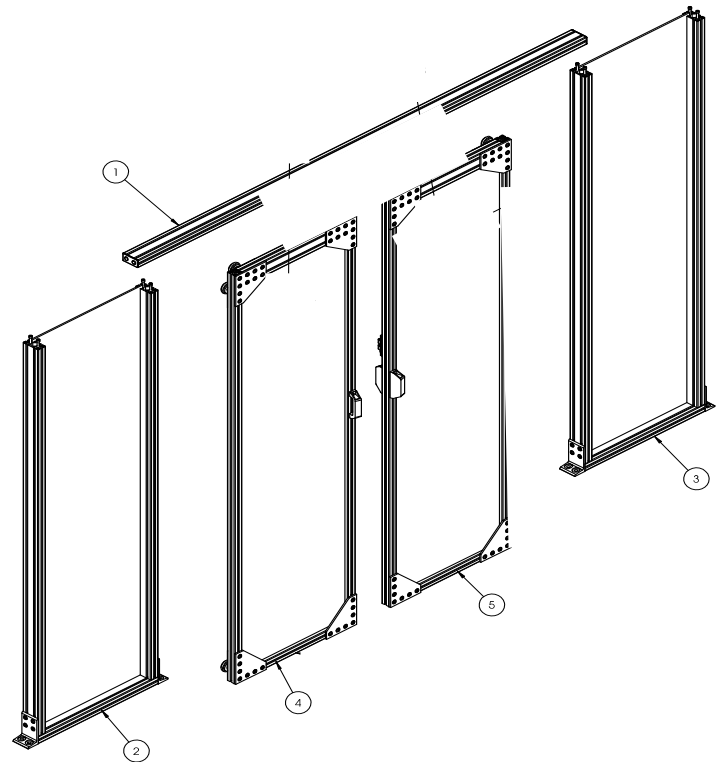

and right hand frame.

Attach the header to the four frame posts using the 5/16" by 1 3/4" screws. When done your frame should appear as below.

Note:

Different floor types (solid, raised) may require different anchoring methods to ensure proper strength. Choose anchors that bolt to the raised floor or solid floor.

Tools Required:

- Drill
 - 3/8 drill bit
 - 3/16 Allen wrench
 - Level
- Adjustable wrenches or Socket Set (SAE)

Procedure:

Step 1:

Unpack the AED. Separate the door from the packing material.

Caution:

Do not cut into the aluminum or clear door material as you separate the packing material from the door. You can easily cut the door material, which would be unsightly.

Step 2:

Assemble the Frame

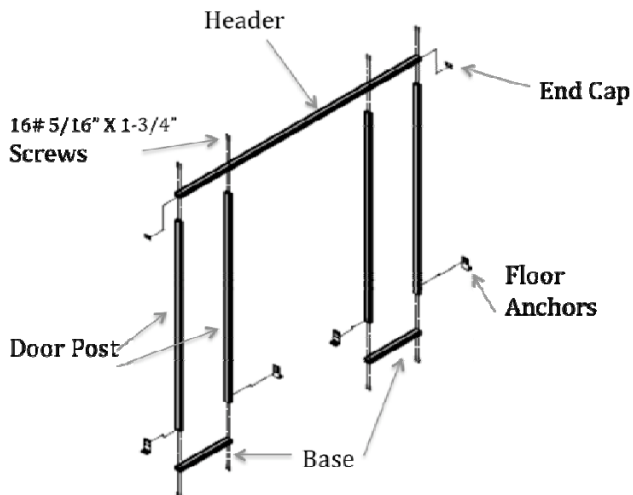

The frame comes assembled with the exception of the header. The header attaches to the left

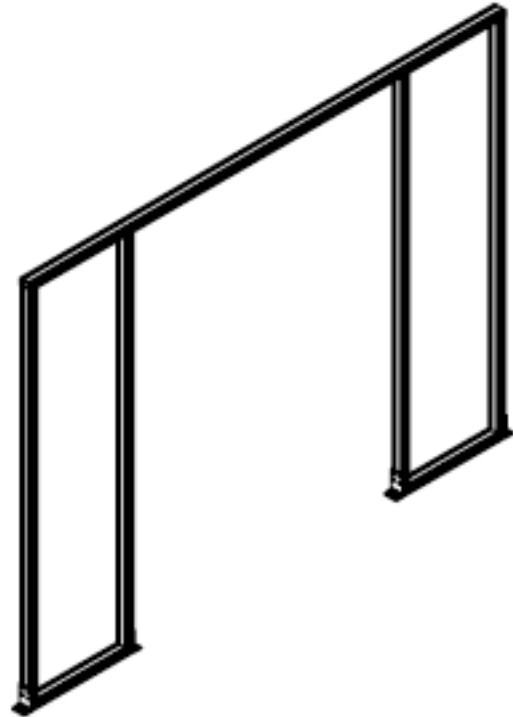

Step 3:

Position the doorframe.



Using two or more people... stand up the frame into what would be its final position. Ensure the frame is placed so it allows for safe entrance and exit from the contained aisle. Likewise ensure the frame fully butts up against

the aisle end racks so as to prevent air from leaking around the sides.

Warning:

The doorframe is heavy. Should it fall it could cause injury or even death. Always secure the door by having at least one person holding it while measuring for final layout.

Note:

Only the frame is required to mark the floor anchors. Do not attach the doors to the frame yet.

Step 4:

Plumb the doorframe.

Once the door is in the desired place attach **one** of the floor anchors on the outside corner. (Reference step 5 below for drilling floor)

Next use a level to determine that the doorpost is plumb. The attached floor anchor will ensure the frame does not move.

Note: It is important that the door frame is installed square and plumb.

Mark the remaining floor anchor points after ensuring door are in final position and is square/plumb.



Step 5:

Drill the floor for remaining anchor brackets.

Drill a 5/16-inch hole on the marks you've made that match the doorframe brackets



Step 6:

Attach the doorframe to the floor

Insert the bolts into the side anchor brackets and through the floor. Attach the nuts to the bolts and secure.

Step 7:

Attach the top of the frame to the aisle end cabinet.

Using the long slotted bracket provided with the door attach one end to the doorframe with the provided hardware. The other end of the bracket with the slotted hole allows attachment to the cabinet using either factory attachments or the self-tapping metal screw provided. The attachment plate allows multiple points to be used for mounting to the cabinets including the sturdy aluminum slotted rail on top of the cabinets.

Secure the doorframe top rail snug against the side of the cabinet on both sides of the aisle. Make sure the frame is plumb and square. See photo below for attachment bracket typical install.



Attachment bracket for top of door header to cabinet.

Note:

There are several ways to attach the frame to the aisle end cabinet. Choose an option that best fits the cabinet design. The key is to hold the frame firmly against the cabinet so that it will remain in place and not create an air gap.

Step 8:

Installing the doors

Place the doors on the frame header. The door is held onto the frame by rollers.

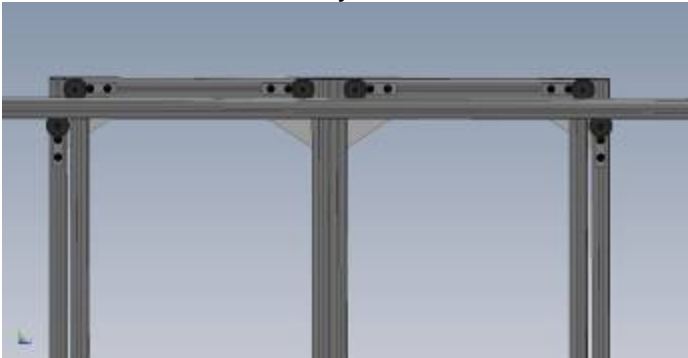

Note:

The rollers on the doors are both above and below the header or top rail.

The finished door should look like this:

slide easily from closed to fully open position.

**Step 9:
Field adjust the door rollers**

The lower roller is a guide wheel that may need minor adjustment to ride in the lower track. First adjust the lower roller, if needed, so the door rolls easily yet is held captive in the track by this lower wheel. Note photo below.



When satisfied that the door is rolling smoothly, slide the upper vertically adjustable roller into the upper frame groove to prevent the door from being able to be lifted off of or removed from the upper frame header.

Loosen the two screws holding the bracket sufficiently to slide the wheel up until it contacts the groove in the bottom of the frame header. Tighten the two screws to hold it in place.

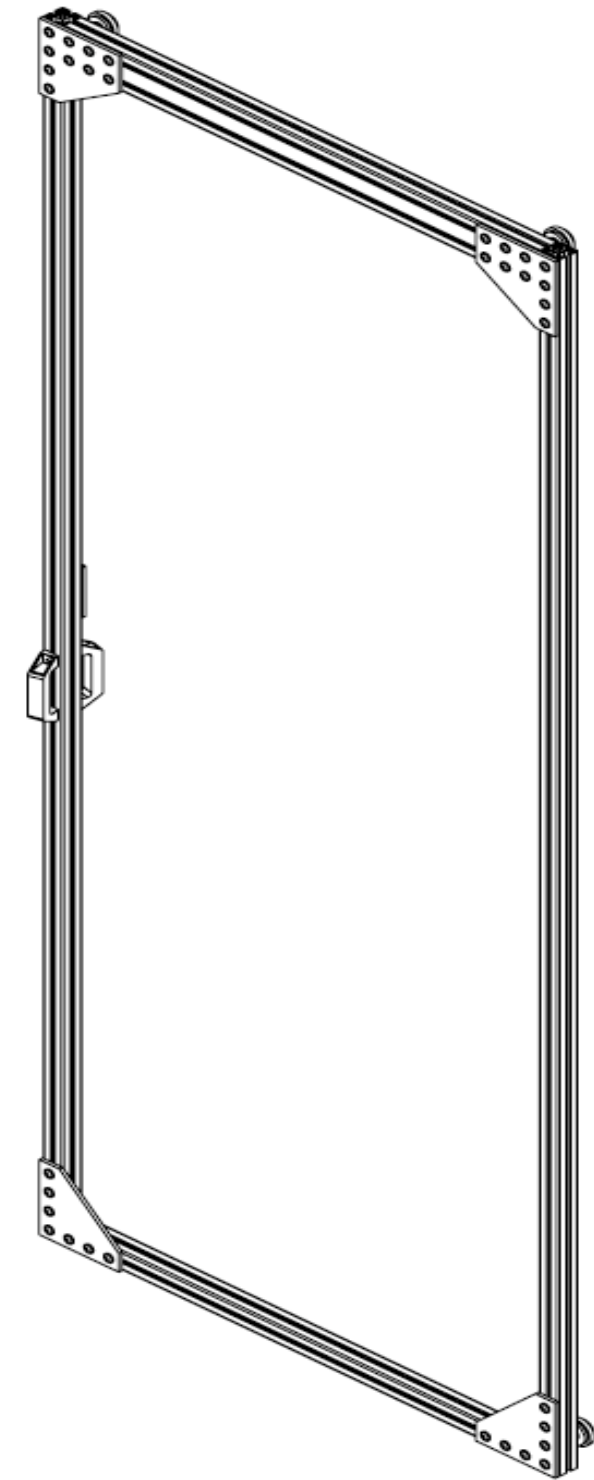

Place each door on the assembled upright attached frame header. Ensure the wheels are in the position as shown. Verify that the doors

**Step 10
Adjust the door latch and handles**

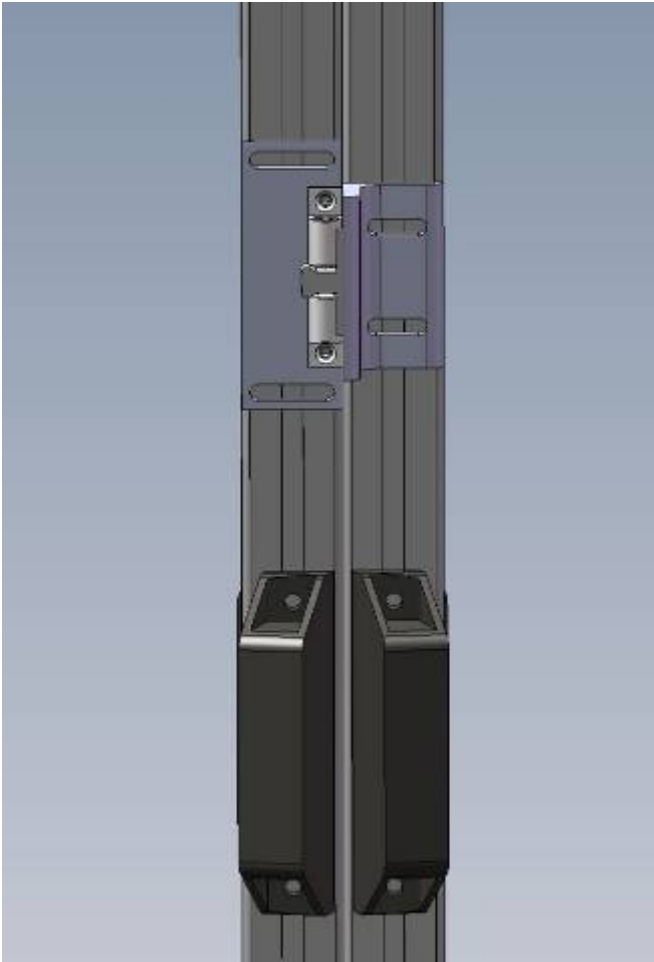

The door latch can now be adjusted so each side fits into one another. Loosen the screws on both the male and the female latch. Insert the latches so they are in the position when the doors are closed. Tighten the screws on the male side. After ensuring the latches remain tight, tighten the female side.

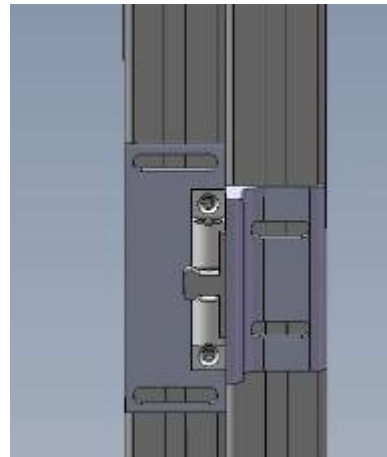

The two screws at the top and bottom of the handle can adjust the door handles. Simply loosen the screws and move to the desired height and tighten. There is a cover over the handle that can be removed to allow for adjustment of the handles.

